



Service Kit Part Number 10084199
ConMet Flat Rotor 10083615
Rotor Minimum Thickness 1.46" (37mm)



ConMet 10083615 Flat Rotor

DISC BRAKE ROTOR REPLACEMENT

NOTE

Install the brake rotor using only the hardware provided in the kit.

If present, retain stainless steel insulator (see image below).

1. If the rotor mounting studs were removed from the hub during disassembly, apply Loctite® 272 to the coarse end of the double-ended stud and to the rotor mounting threads in the hub. (If Loctite® 272 is not available, use Loctite® 262.) Install and torque the rotor studs to 65 ft-lbs. for iron hubs and 50 ft-lbs. for aluminum hubs.
2. Clean all mating surfaces.
3. Place the stainless steel insulator (for aluminum hubs only) and the rotor on the hub.
4. Install and torque the new, included rotor mounting nuts in a star pattern to 200 ft-lbs.
5. Place the ABS tone ring on the rotor.
6. Install and torque the new, included 1/4-20 UNF button head screws in a star pattern to 160 in-lbs.

1. Hub Assembly (not included)
2. Stainless Steel Insulator (not included, for aluminum hubs only)
3. 10083615 Flat Rotor
4. 5/8"-18 UNF Flanged Hex Head Nut (10 ea.)
5. ABS Tone Ring
6. 1/4-20 UNF button head screws (5 ea.)

See ConMet Service Manual for detailed hub service information.

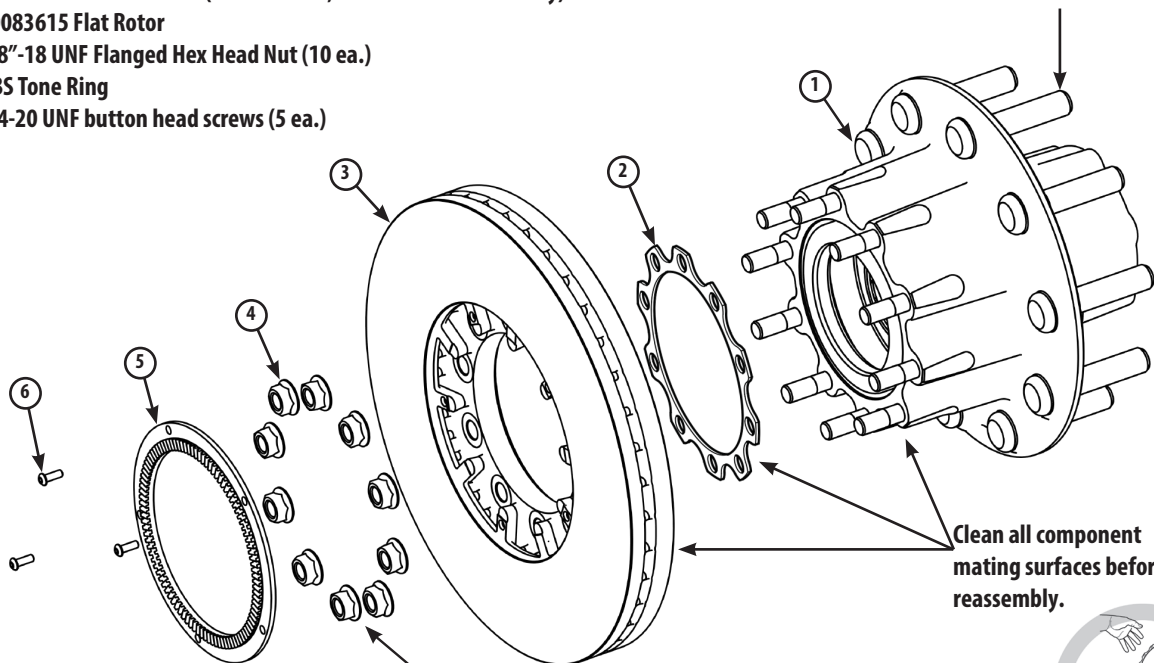

Clean all component mating surfaces before reassembly.

5/8-18 UNF flanged hex head nuts.
Torque to 200 ft-lbs in a star pattern.

1/4-20 UNF button head screws.
Torque to 160 in-lbs in a star pattern.



DO NOT THROW AWAY STAINLESS STEEL INSULATOR