

FCM Fixed Skylight

Technical Product Data Sheet

Description

- FCM Fixed Curb Mount Skylight that mounts to a site-built curb (residential curbs typically 2x4 or 2x6). Fixed skylight, provided with various insulated glass units. Manufactured with a neutral gray aluminum profile and integral gasket preventing air and water infiltration while allowing the removal of interior condensation.

Installation

- No designated top, bottom, or sides for installation in any direction.
- Single unit applications only (combination applications not possible).
- 0 degrees to 60 degrees, use standard installation procedure.
- Above 45 degrees, use water diverter as illustrated in installation instructions; water diverter provided by installer.

Flashings

- ECL – Engineered neutral gray flashing for single installation with thin roofing material ($\frac{1}{2}$ " max) for roof pitch above 10-60 degrees.
- ECW – Engineered neutral gray flashing for single installation with tile (over $\frac{3}{4}$ ") roofing material for roof pitch above 14-60 degrees.
- Applications less than 10-degree roof pitch - flashing provided by others.

Interior Accessories

- Accessory Tray; mounts to curb required for installation of shades.
- FSCC - Solar powered Room darkening - double pleated shade.
- FSLC - Solar powered Light filtering - single pleated shade.

Type Sign

- Example: FCM 2222 0004D 01BF05
- Etched on bottom right of exterior frame cover.



Standard Sizes

- 1430, 1446, 2222, 2230, 2234, 2246, 2270, 3030, 3046, 3055, 3434, 3446, 4646, 4672
- Custom sizes available.

Special Stocked Sizes

- 190365, 190435, 210455, 225225, 225470, 245245, 245470, 245490, 260540, 280525, 315315, 315470, 315700, 315715, 365365, 385385, 385540, 420435, 460470, 460700

Warranty

- **Skylight** – 10 years from the date of purchase; VELUX warrants that the skylight will be free from defects in material and workmanship.
- **Installation** – 10 years from the date of purchase; VELUX No Leak Warranty warrants skylight installation. Must be installed with VELUX flashings and included adhesive underlayment.
- **Glass Seal** – 20 years from the date of purchase; VELUX warrants that the insulated glass pane will not develop a material obstruction of vision due to failure of the glass seal.
- **Hail Warranty** – 10 years from the date of purchase; VELUX warrants only laminated glass panes against hail breakage.
- **Accessories and Electrical Components** – 5 years from the date of purchase; VELUX warrants Velux shades and control systems will be free from defects in material and workmanship.

Cross Section

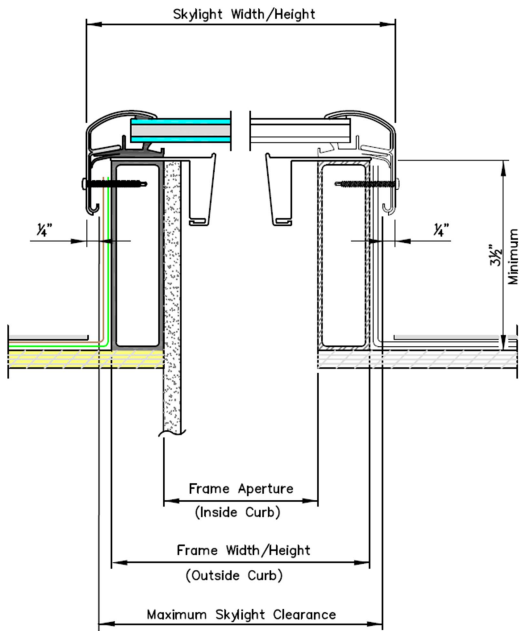

| Size | Inside Curb | Outside Curb | Make Size |
|------|-------------|--------------|-----------|
| 14 | 14-1/2" | 17-1/2" | 18-5/8" |
| 22 | 22-1/2" | 25-1/2" | 26-5/8" |
| 30 | 30-1/2" | 33-1/2" | 34-5/8" |
| 34 | 34-1/2" | 37-1/2" | 38-5/8" |
| 46 | 46-1/2" | 49-1/2" | 50-5/8" |
| 55 | 55-1/2" | 58-1/2" | 59-5/8" |
| 70 | 70-1/2" | 73-1/2" | 74-5/8" |
| 72 | 72-1/2" | 75-1/2" | 76-5/8" |

| Custom Sizes | Width | Length |
|--------------|---------|---------|
| Min | 18-3/4" | 18-3/4" |
| Max | 50-3/4" | 76-1/2" |

Glazings and Certification

| Glazing | NFRC U-factor | NFRC SHGC | NFRC Vt | Hallmark 426-H-701 | IAPMO-ES ER 199 | Fla Prod Approval 13303 | HVHZ | TDI |
|---|---------------|-----------|---------|--------------------|-----------------|-------------------------|------|-------|
| 04 Laminated – 2.3 mm laminated (0.76 mm interlayer) with tempered Low E366 outer pane. | 0.48 | 0.27 | 0.63 | ✓ | ✓ | ✓ | | SK-03 |
| 05 Tempered – 3 mm tempered clear with tempered Low E366 outer pane. | 0.45 | 0.28 | 0.63 | ✓ | | ✓ | | SK-03 |
| 06 Impact – 2.3 mm laminated (2.28 mm interlayer) with tempered Low E366 outer pane for hurricane areas | 0.46 | 0.27 | 0.63 | ✓ | ✓ | ✓ | ✓ | SK-14 |
| 08 White laminated – 2.3 mm Laminated (0.76mm white interlayer) with tempered Low E366 outer pane. | 0.48 | 0.27 | 0.57 | ✓ | ✓ | ✓ | | SK-03 |
| 10 Snowload – 3 mm laminated (0.76 mm interlayer) with tempered Low E366 outer pane. | 0.47 | 0.27 | 0.63 | ✓ | | | | |
| 14 Laminated – 2.3 mm laminated (0.76 mm interlayer) with tempered Low E340 outer pane. | 0.48 | 0.18 | 0.38 | ✓ | | ✓ | | SK-03 |
| 15 Tempered – 3mm tempered clear with tempered Low E340 outer pane. | 0.49 | 0.18 | 0.38 | ✓ | | ✓ | | SK-03 |
| 16 Impact – 2.3 mm laminated (2.28 mm interlayer) with tempered Low E340 outer pane. | 0.46 | 0.18 | 0.38 | ✓ | | ✓ | ✓ | SK-14 |
| 29 Laminated Triple Pane – 2.3 mm laminated (0.76mm white interlayer), with 3 mm tempered middle pane, and tempered Low E366 outer pane. | 0.38 | 0.25 | 0.57 | ✓ | ✓ | ✓ | | |
| 30 Tempered Triple Pane – 3 mm tempered clear with 3mm tempered middle pane and tempered Low E366 outer pane. | 0.38 | 0.25 | 0.58 | ✓ | | ✓ | | |

Consult with Customer Service for special glazing options.

