

695 mm (27 3/8")

659 mm (25 15/16")

# ICMS-010 MOUNTING TEMPLATE

For all other wiring and installation instructions, refer to the Instruction Manuals supplied with the ICMS-010.



## WARNINGS & SAFETY INSTRUCTIONS

### ▲ WARNING

Risk of electric shock. Do not expose the ICMS-010 to rain, snow, spray, liquid, or dust. Doing so may result in damage to the Inverter and other appliances installed in the system or result in electric shock or fire.

### ▲ CAUTION

- Lifting a heavy object can cause muscle strain or back injury. Use lifting aids if needed, and proper lifting techniques when mounting the ICMS-010. If you are not comfortable lifting the ICMS-010 on your own, get somebody to help you.
- Two people are required to safely lift the ICMS-010 above shoulder height.
- Use suitable Personal Protective Equipment (PPE) when operating power tools.



### NOTICE

Do NOT modify the mounting holes on the ICMS-010 in any way. Modification to the unit will void the warranty.

## RECOMMENDED FASTENERS

The following fasteners are recommended for secure and safe mounting of the ICMS-010. If you choose to use alternative fasteners, make sure they are equivalent.

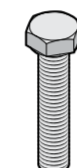

### HIGH-TENSILE BOLT x 4

M8 (5/16") — metric class 8.8 or imperial grade 5 minimum. Length determined by mounting surface thickness.



### FLAT WASHER x 8

M8 x 16 mm x 1.6 mm (5/16" x 5/8" x 16 gauge). Washer outer diameter must not exceed 25 mm (1").



### MUDGUARD/FENDER WASHER x 4

M8 x 25 mm x 1.6 mm (5/16" x 1" x 16 gauge).



### NYLON LOCK NUT x 4

M8 (5/16") — metric class 8.8 or imperial grade 5 minimum.



## MOUNTING CHECKLIST — BEFORE YOU BEGIN

The ICMS-010 should only be mounted and used in a location that meets the following criteria:

### ☐ STRUCTURAL

Mount only to a fixed, flat, structural surface **using all four mounting holes**. Use appropriate M8 (or 5/16") fasteners (not supplied).

### ☐ DRY

Do not allow water to drip onto or enter the ICMS-010.

### ☐ COOL

Ambient air temperature should be between 0°C and 40°C (32°F and 104°F).

### ☐ SAFE

Do not install the ICMS-010 in a battery compartment or other areas where volatile fumes may exist, such as fuel storage areas or engine compartments.

### ☐ VENTILATED

Keep the ICMS-010 at a distance of at least 50 mm (2") away from surrounding objects. Ensure all ventilation openings are not obstructed.

### ☐ DUST-FREE

Do not install the ICMS-010 in a dusty environment where the dust can enter, and especially cannot be drawn into the cooling fan on the Inverter.

### ☐ NEAR TO BATTERIES

Avoid excessive cable runs between batteries and the ICMS-010 to reduce voltage drop across the cables. For safety reasons however, even when installed in a well ventilated area the ICMS-010 should not be installed within 300 mm (12") of a battery. The ICMS-010 must not be installed within the same enclosed compartment as a battery.

### ☐ NON-CORROSIVE

Do not mount the ICMS-010 where it will be exposed to the gasses produced by a battery. These gasses are very corrosive, and prolonged exposure will damage the ICMS-010.

### ☐ CORRECT MOUNTING ORIENTATION

Mounting the ICMS-010 horizontally is ideal, however vertically is acceptable. Do not mount the ICMS-010 upside down.

## MOUNTING STEPS

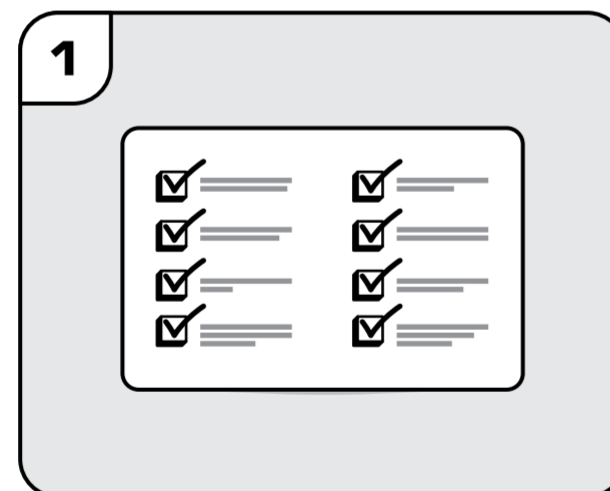

1 Confirm that your chosen mounting location and orientation meets all criteria listed in 'Mounting Checklist — Before You Begin'

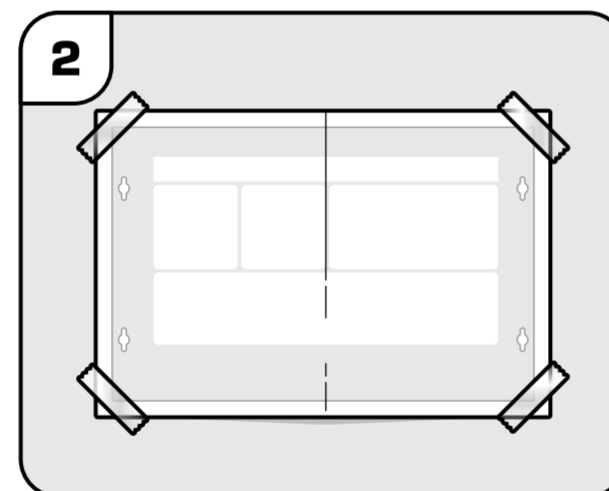

2 Tape this Mounting Template in the mounting location, making sure the template is completely flat.

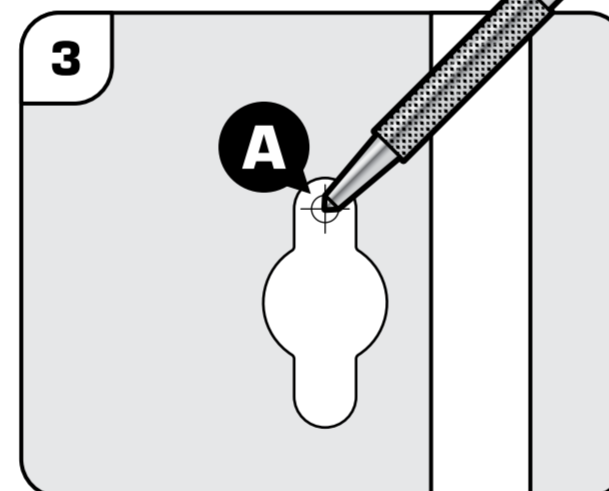

3 Use a centre-punch to punch the centres of the mounting points (marked 'A'). **Note, all four Mounting Points must be used.**

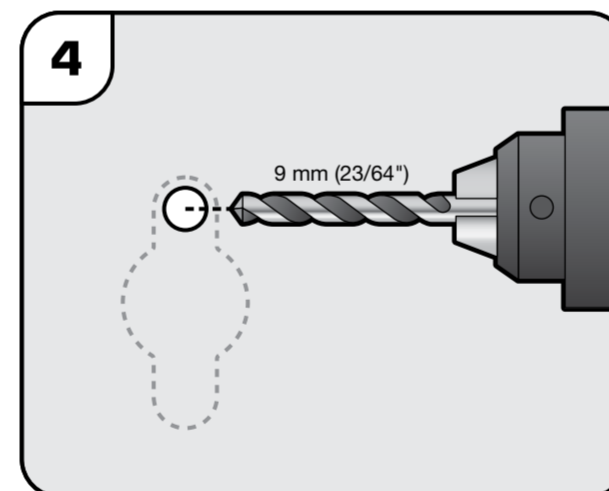

4 Remove the Template then drill clearance/pilot holes using a 9 mm (23/64") drill bit (or drill bit size for your chosen fasteners). De-burr the holes and touch up any bare metal surfaces that have been exposed with a rust inhibitor (e.g. primer).

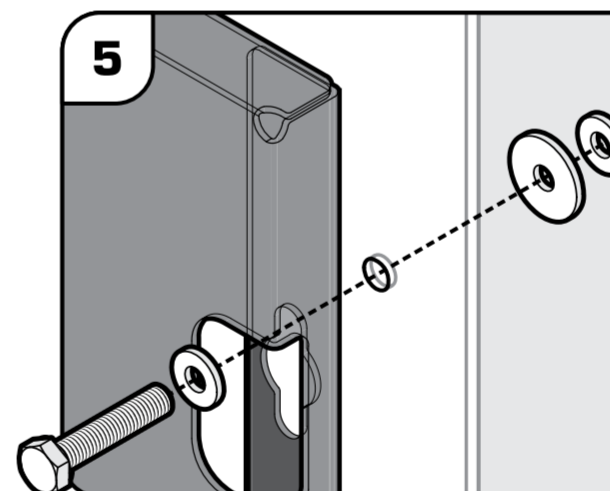

5 Fasten the ICMS-010 in place using your chosen fasteners. Get someone to help you lift and locate the unit safely if needed.

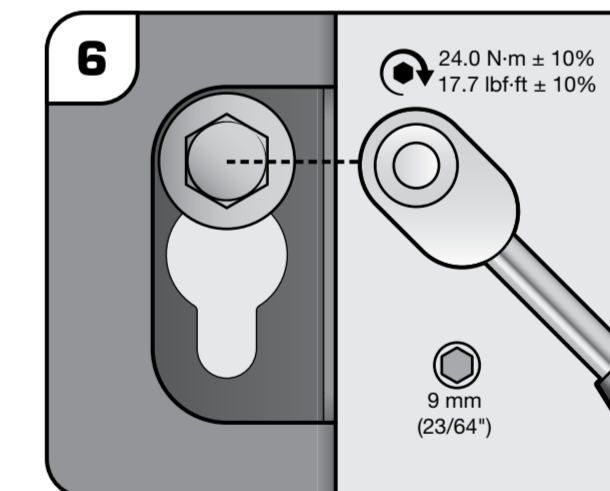

6 Torque to 24.0 N-m/17.7 lbf-ft if using the recommended fasteners, or torque appropriately for your chosen fastener grade.



## PRINT THIS PAGE AT 100% SCALE

Before drilling holes, make sure that this template is printed at the correct size.