

Floorplan

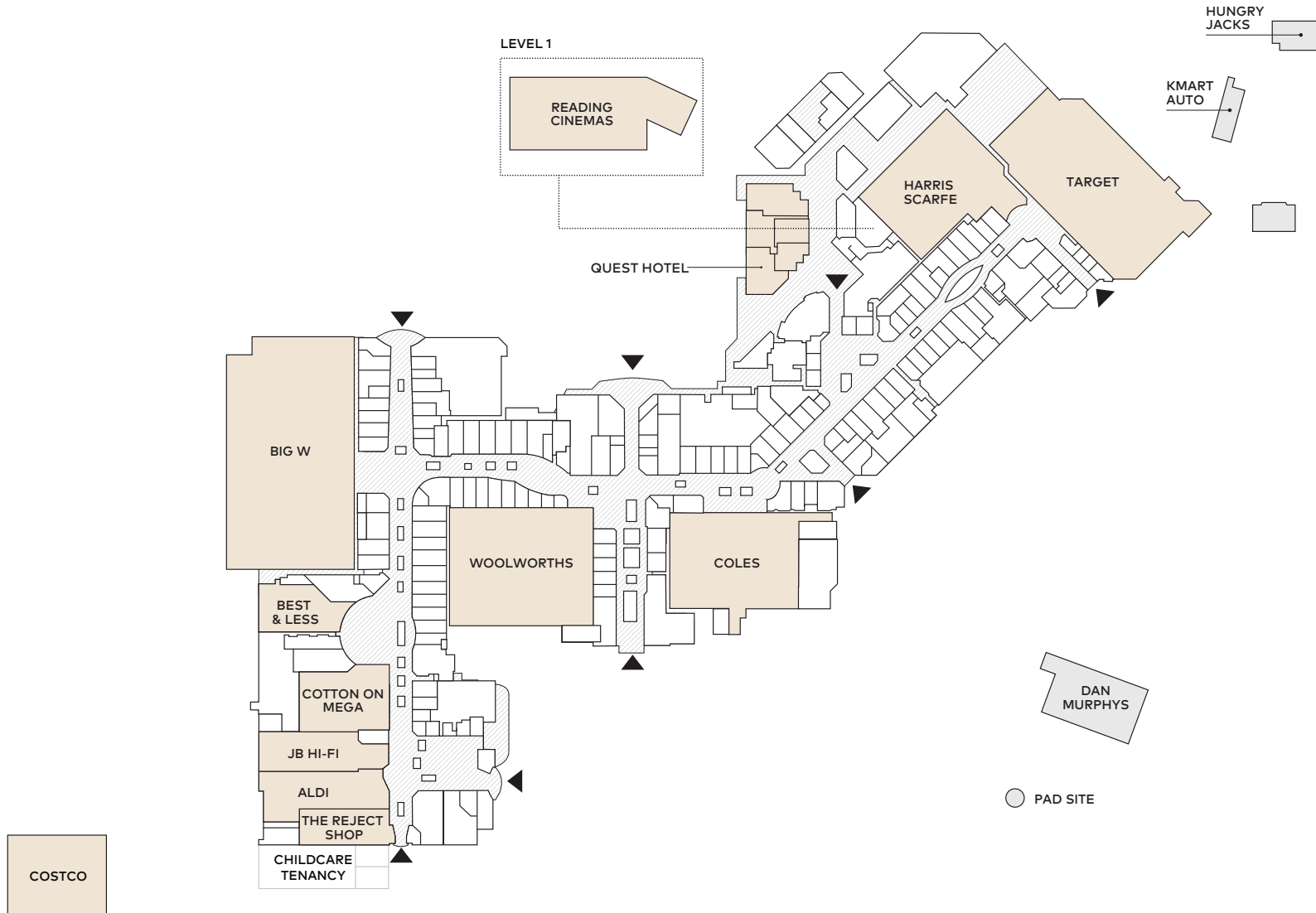

The Centre is owned by GIC Epping Pty Ltd (ACN 624 121 508) and Bevendale Pty Ltd (ACN 006 392 267) and is managed by GICP Pty Ltd (ACN 075 744 151). Benvendale Pty Ltd (ACN 006 392 267), GIC Epping Pty Ltd (ACN 624 121 508) and GICP Pty Ltd (ACN 075 744 151) ("GIC") and their respective associated companies, subsidiaries, agents and employees (the "GIC Parties") disclaim all responsibility and liability for any loss or damage of any nature whatsoever which may be suffered by any person directly or indirectly through relying on the information contained in this document (the "Information"), whether that loss or damage is caused by any fault or negligence of the GIC Parties or otherwise. A number of the statements are based on information and research published by others. No GIC Party has confirmed, and GIC does not warrant, the accuracy or completeness of such statements. Past performance is not a reliable indicator of future performance. Plans, drawings, photographs and illustrations are indicative only. GIC reserves the right to change any part of the proposed development, design and the tenancy mix from that shown or described in this document. The Information includes statements and estimates in relation to future matters, many of which are based on subjective judgements or proprietary internal modelling. No representation is made that such statements or

estimates will prove correct. You should be aware that the Information is predictive in character and may be affected by inaccurate assumptions and/or by known or unknown risks and uncertainties. Forecast results may differ materially from results ultimately achieved. The Information does not constitute advice (including financial advice) and you should seek advice before relying on it and before entering into a lease. In preparing this Information the GIC Parties have not taken into account any objectives, financial situations or needs. This document is being given solely for general information purposes. This document does not constitute an offer document in respect of any premises or space. Neither this document nor anything contained in it nor any presentation in connection with it will form the basis of any contract or any obligation of any kind whatsoever. No such contract or obligation will be formed until all relevant parties execute a written contract. Copyright GIC Limited, Australia 2019. All rights are reserved. Do not copy, disseminate or use, except in accordance with the prior written consent of GIC.