

Quick Start Installation Guide

Zip HydroTap G5



Command Centre
Boiling/Chilled models



AFFIX PRODUCT LABEL HERE

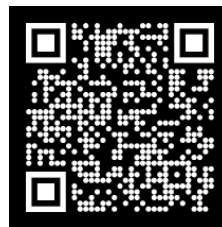

Australia



UK

Visit our website to
download the manuals

Table of contents

SECTION 1: Using the instructions.....	3
SECTION 2: IMPORTANT SAFETY INSTRUCTIONS.....	4
SECTION 3: WARNINGS AND REGULATORY INSTRUCTIONS.....	6
SECTION 4: Technical data	8
SECTION 5: Supplied parts checklist	10
SECTION 6: Set up the ventilation.....	11
SECTION 7: Connect the water supply	14
SECTION 8: Set the bypass & install the scale filter	15
SECTION 9: Fit the Booster.....	16
SECTION 10: Connect the Booster	17
SECTION 11: Connect the Command Centre.....	18
SECTION 12: Commissioning.....	21
Contact details	24

SECTION 1: Using these instructions

Before you start



This document is a Quick Start Installation Guide.
For further details on installing and operating your HydroTap
download & read the Command Centre installation and user
instructions , which can be found online at:

(Australia) www.zipwater.com

(UK) specify.zipwater.co.uk



Read and use the instructions supplied with individual kit
components for a safe installation.

Explanation of symbols



Read the
instructions



WARNING



Danger of
electric shock



Hot surface



Highly
Flammable



Compliance

In Australia electrical installation must comply with AS/NZS3000.

In Australia plumbing installation must comply with AS/NZS3500.

In Australia For residential chilled models, all refrigeration must comply with AS/NZS 60335.2.24.

In the UK the system must be installed in accordance with water supply byelaws, current IEE regulations and local authority byelaws.

Safety

This appliance is not intended for use by children under 8 years or persons (including children under 8 years) with reduced physical, sensory or mental capabilities, or lack of experience and knowledge, unless they have been given supervision or instruction concerning the use of the appliance by a person responsible for their safety. Children should be supervised to ensure that they do not play with the appliance.

Intended Use

This appliance is intended to be used in: staff kitchen areas in shops, offices and other working environments; farm houses and by clients in hotels, motels and other residential type environments; bed and breakfast type environments; catering and similar non-retail applications.



Refrigerant

WARNING! KEEP VENTILATION OPENINGS IN THE APPLIANCE ENCLOSURE OR IN THE BUILT-IN STRUCTURE CLEAR OF OBSTRUCTION.

The Zip HydroTap Command Centre range uses either HIGHLY FLAMMABLE R290, R600a or R134A refrigerant under pressure.

Check the rating plate or contact Zip before commencing work.

Maintenance of the refrigeration unit must be carried out by an accredited service provider or qualified refrigeration technician.

Do not use mechanical devices or other means to accelerate the defrosting process, other than those recommended by the manufacturer.

SECTION 2: IMPORTANT SAFETY INSTRUCTIONS

Do not store explosive substances such as aerosol cans with a flammable propellant in this appliance.

Qualifications

To avoid hazards, all installation procedures must be carried out by a suitably qualified tradesperson. The power cable and power outlet must be in a safe visible position for connection.

Venting

Sometimes steam and / or boiling water droplets may discharge through a vent outlet on the tap. If not using the font, ensure the tap body is located so the tap outlet safely dispenses into the sink bowl.

Lifting

Take care when lifting. The Command Centre may exceed safe lifting limits. If you feel this is beyond your personal capabilities, please seek assistance with the lift. The weight of the Command Centre is marked on the packaging. Do not lift the Command Centre by the front cover or any of its connections.

Airflow

The Zip HydroTap operates within the ambient temperature range 5°C - 35°C. Proper air circulation must be provided. The system will operate satisfactorily only if the recommended air gaps are provided. The vent kit supplied must be fitted.

Altitude

Water boils at varying temperatures at different altitudes. The HydroTap adjusts for this during startup calibration and will recalibrate itself on a regular basis.

Frost protection

If the HydroTap is located where the ambient air temperature could fall below 5°C when the system is not in use, do not turn off the Command Centre electrically. This safeguard does not offer the same protection to the connecting pipework and fittings.

SECTION 3: WARNINGS & REGULATORY INFORMATION



- For continued safety of this appliance it must be installed, operated and maintained in accordance with the manufacturer's instructions.



- This appliance may deliver water at high temperature. Refer to the Plumbing Code of Australia (PCA), local requirements and installation instructions to determine if additional delivery temperature control is required.

-  The Zip HydroTap must be earthed. Earthing is provided via the supplied power cord. The resistance of the earth connection to each exposed metal part must be less than 1Ω. Use the power cable supplied. It is the responsibility of the installer to ensure the power point is earthed.
- All installation and service work must be completed by trained and suitably qualified tradespeople. Faulty operation due to unqualified persons working on this product may void warranty coverage.
- As the installer, it is your responsibility to supply and install all valves as required by local regulations and relevant standards.
- The HydroTap is rated for 220-240V 50Hz AC operation.
- Do not remove the cover of the appliance under any circumstances without first isolating the appliance from the power supply.
- Connect only to a potable (wholesome, cat1) mains water supply.
- The new hose sets supplied with the product must be used. Do not re-use old hose sets.
- Never locate the system near, or clean with water jets.
- Do not expose the Zip HydroTap to the elements of nature. The booster complies with protection class IP 20.
- For UK, a pressure limiting valve must be fitted for mains water pressures above the maximum limits stated.
- Use of tools can be hazardous. Assess the risks before you start.

SECTION 3: WARNINGS & REGULATORY INFORMATION

- A clearance envelope around all Command Centres must be provided to allow adequate ventilation for the safe and effective use of the HydroTap system.
- Valve and fitting threads must be sealed appropriately with PTFE tape where compression seals are not provided.
- Always flush new filter before use.
- Do not connect Booster to electrical supply until commissioning.
- Do not over tighten plumbing and hose connections.
- Braided hoses supplied cannot be lengthened.
- The power cord and general power outlet must be in a safe and accessible position after installation. When positioning the appliance, ensure the power supply cord is not trapped or damaged. If the power supply cord is damaged it must be replaced by a Zip service provider or a qualified electrician.
- Do not locate multiple portable socket-outlets or portable power supplies at the rear of the appliance.
- For safe operation, the HydroTap is designed to be installed, commissioned and used within 48 hours. Should the HydroTap not be required for an extended period of time (72 hours or more), do not fill and commission the HydroTap until ready for first use.
- For water taste and quality reasons, following any non-use period of more than 72 hours, Zip recommends to perform a system flush. Failure to flush the system may affect water quality.
- For UK, this appliance incorporates adequate backflow prevention in accordance to S.I.1999 No.1148 The Water Supply (Water fittings) Regulations 1999 Schedule 2 requirement. No further backflow prevention is required for connection to the water supply.
- For UK, this appliance only contains materials that conform to the requirements of BS6920:2014 'Suitability of non metallic materials and products for use in contact with water intended for human consumption with regard to their effect on the quality of water'.

SECTION 4: Technical data

Model	Power rating, kW	Dimensions	Weight (kg)
	220-240V, 50Hz	W x D x H (mm)	
BC100 BC100 H	2.1 + Booster	395 x 464 x 333 With Duct and Vent Tray: 450 (500) [#] x 464 (520) [#] x 333 (373) [#]	30
BC60 BC60 H	2.1	395 x 464 x 333 With Duct and Vent Tray: 450 (500) [#] x 464 (520) [#] x 333 (373) [#]	30
BC40 BC40 H	1.97	395 x 464 x 333 With Duct and Vent Tray: 450 (500) [#] x 464 (520) [#] x 333 (373) [#]	30
BC30 BC30 H	1.9 + Booster	280 x 455 x 333	23
BC20 BC20 H	1.9	280 x 455 x 333	23
BC Home BC H Home	1.44	280 x 455 x 333	30

[#]Including vent tray

Electricity supply requirements

220-240V 50Hz AC (for power requirement see table above).

	Without booster	With booster
Australia	1x 220 - 240V AC 10A socket	2x 220 - 240V AC 10A sockets
UK	1x 220 - 240V AC 13A socket	2x 220 - 240V AC 13A sockets

Water supply pressure requirements

Component	Min - Max pressure, kPA (bar)	
	Australia	UK
HydroTap	170 (1.7) - 700 (7.0)	170 (1.7) - 500 (5.0)
Vented Mixer Tap	300 (3.0) - 700 (7.0)	200 (2.0) - 500 (5.0)
Booster	200 (2.0) - 700 (7.0)	200 (2.0) - 500 (5.0)
Limescale filter	200 (2.0) - 700 (7.0)	200 (2.0) - 500 (5.0)



A pressure limiting valve must be fitted for mains water pressures above the maximum limits stated above in accordance with local plumbing regulations.

Note: All models (excluding UK) have an internal pressure limiting device to reduce the maximum mains regulated pressure (700kPa in Australia), protecting the system against pressure surges above 500kPa.

Water supply connection

1/2" BSP (G1/2).

Booster specification

Specification	Rating
Power 230V 50/60Hz	2.20kW
Power 240V 50/60Hz	2.40kW
Flow rate	1.2 L/min

SECTION 5: Parts supplied

Parts supplied with the HydroTap	BC for Work	BC H for Work	BC for Home
Tap			
HydroTap tap	✓		✓
HydroTap pipes, tubes hoses and fittings	✓		✓
Separate vented Mixer tap kit	✗	✓	✗
Separate Mains mixer Tap	Optional		Optional
Separate Mains mixer Tap fittings	Optional		Optional
Separate Mains mixer Tap instructions	Optional		Optional
Command Centre			
Command Centre	✓		✓
Mains electrical supply cable	✓		✓
Water supply inlet hose	✓		✓
Water supply inlet adaptor and strainer	✓		✓
Ventilation kit (inc. vent tray 100 -40 models)	✓		✓
Water block kit	(UK only)		(UK only)
Booster			
Booster & hoses	Optional		✗
Filters			
Water filter & instructions	✓		✓
Limescale filter kit	Optional		Optional
Font			
Font kit	Optional		Optional

Note: Mains water isolation valve is not supplied with the kit.
Contact Zip for the full range of consumables and accessories.

SECTION 6: Set up the ventilation



Use of tools can be hazardous. Assess the risks before you start.



Use instructions supplied with individual kit parts.



A clearance envelope around all Command Centres must be provided to allow ventilation for the safe and effective use of the HydroTap system.

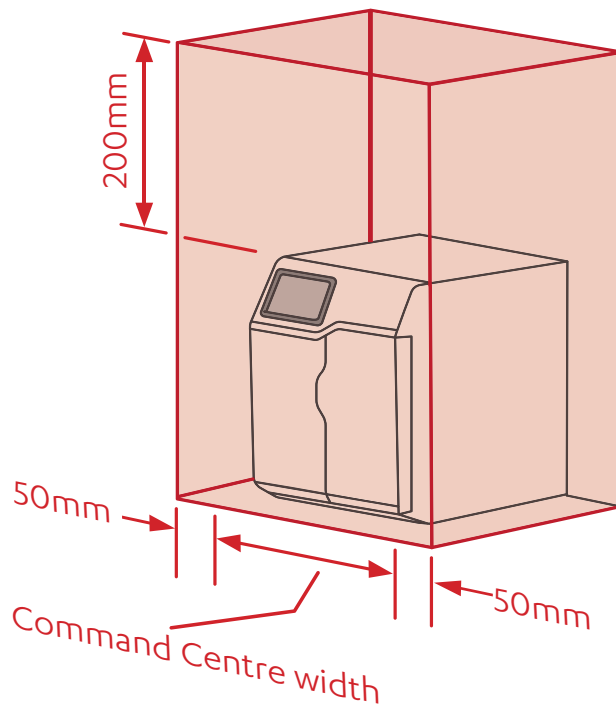

BC100 - BC40 models

- Cold air is drawn in through the inlet vent and gap provided by the door buffers.
- Inlet vent is mounted over cupboard side, door or floor cut-out (see below).
- Warm air is exhausted through vent tray.
- Observe 100mm inlet / outlet vent separation (see below).



The vent tray must be fitted. It provides a safe exhaust for refrigerant gas in the unlikely event of a leak.

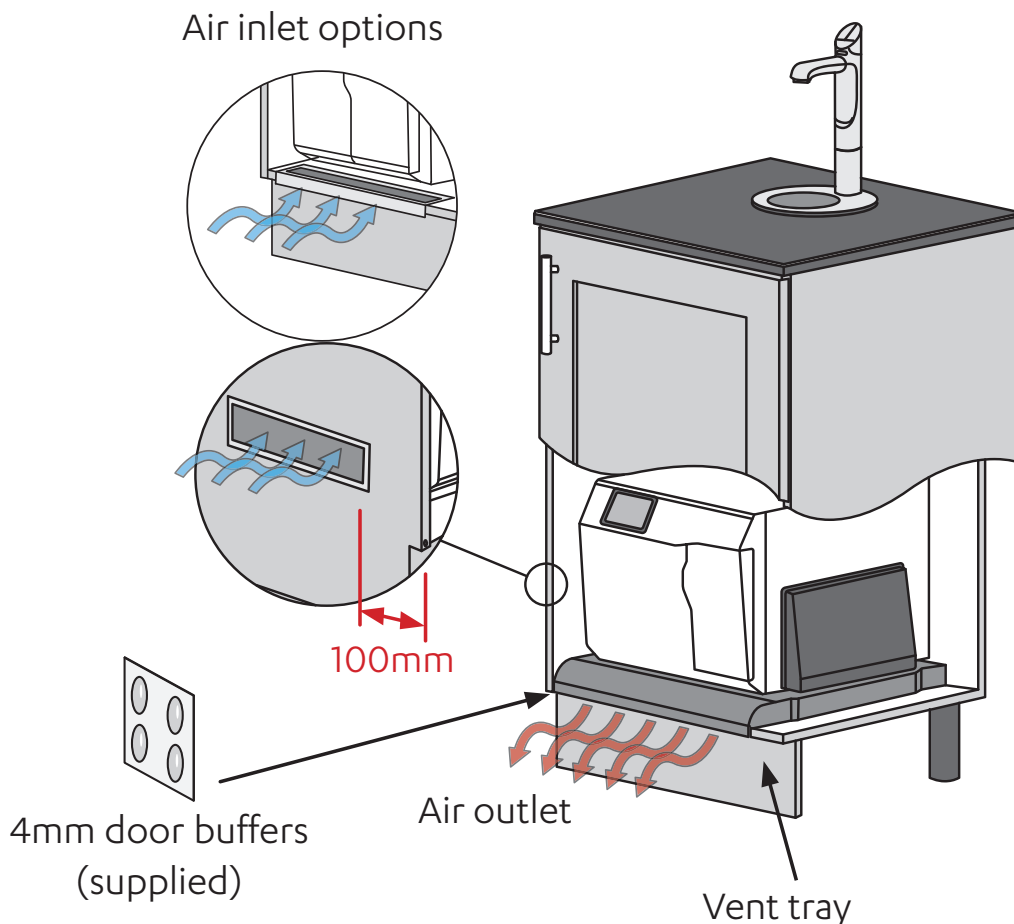

Vent tray dimensions WxDxH (mm): 500 x (515-555) x 40

SECTION 6: Set up the ventilation

BC30, BC20 & Home models

- Cold air is drawn in through the inlet vent and lower gap provided by the door buffers.
- Inlet vent is mounted over cupboard side, door or floor cut-out.
- Warm air is exhausted through upper gap provided by the door buffers.

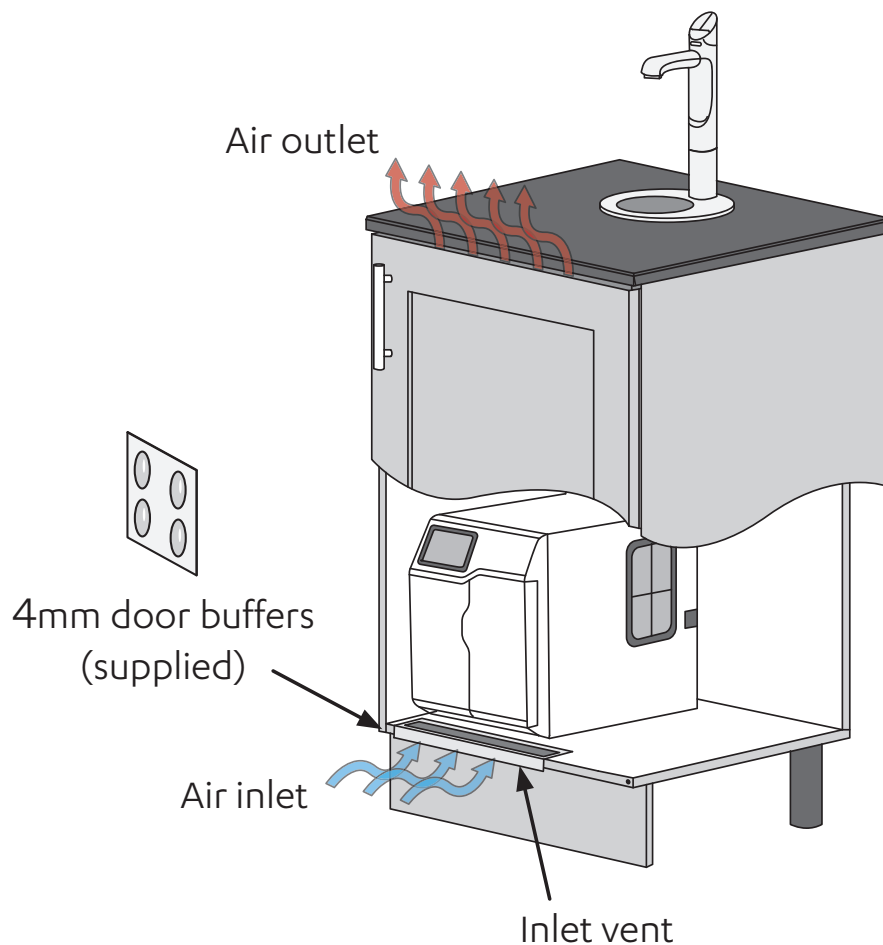

All models

If cupboard temperature exceeds 35°C, additional ventilation is required. Contact your Zip service provider for options (including additional vents and fan kit).

SECTION 7: Connect the water supply



Valves and fittings must be sealed with PTFE tape if compression seals are not included.

Note Mixer tap installations also use a 'Tee piece' as part of the water supply plumbing connections, see the Tap installation instructions supplied with the Mixer Tap to connect the water supply if using the mixer tap option.

Note correct strainer orientation.

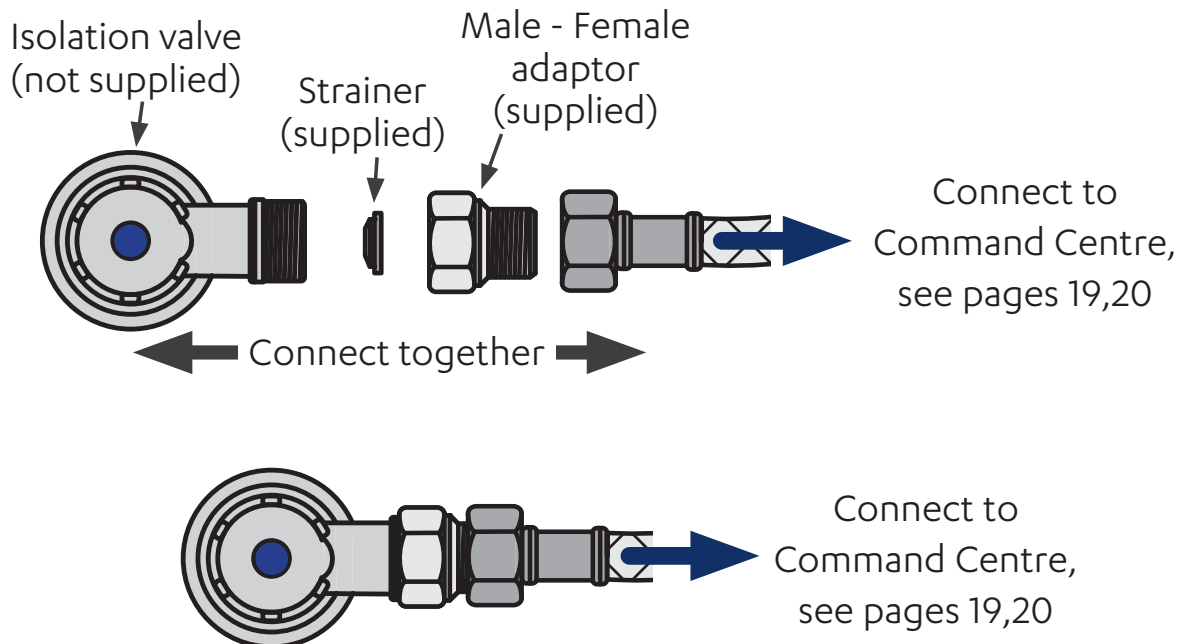

SECTION 8: Set the bypass & install the limescale filter

Available as optional accessory - UK only.



For filter head and scale filter installation use the guide supplied with the filter head and filter respectively.

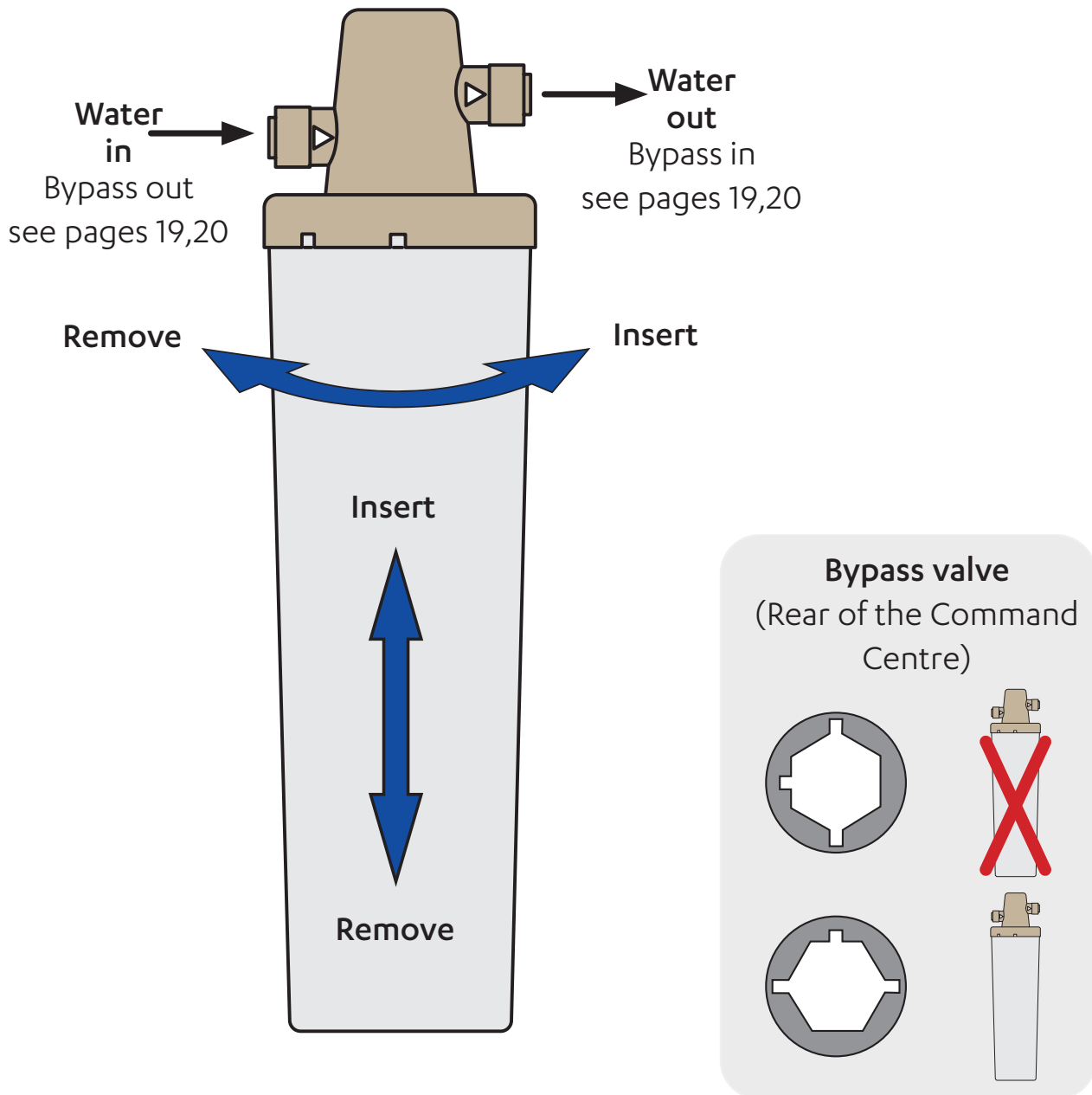

SECTION 9: Fit the Booster

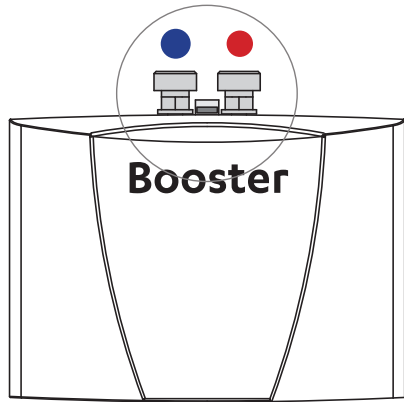

- Supplied with selected models, or available as an optional accessory.

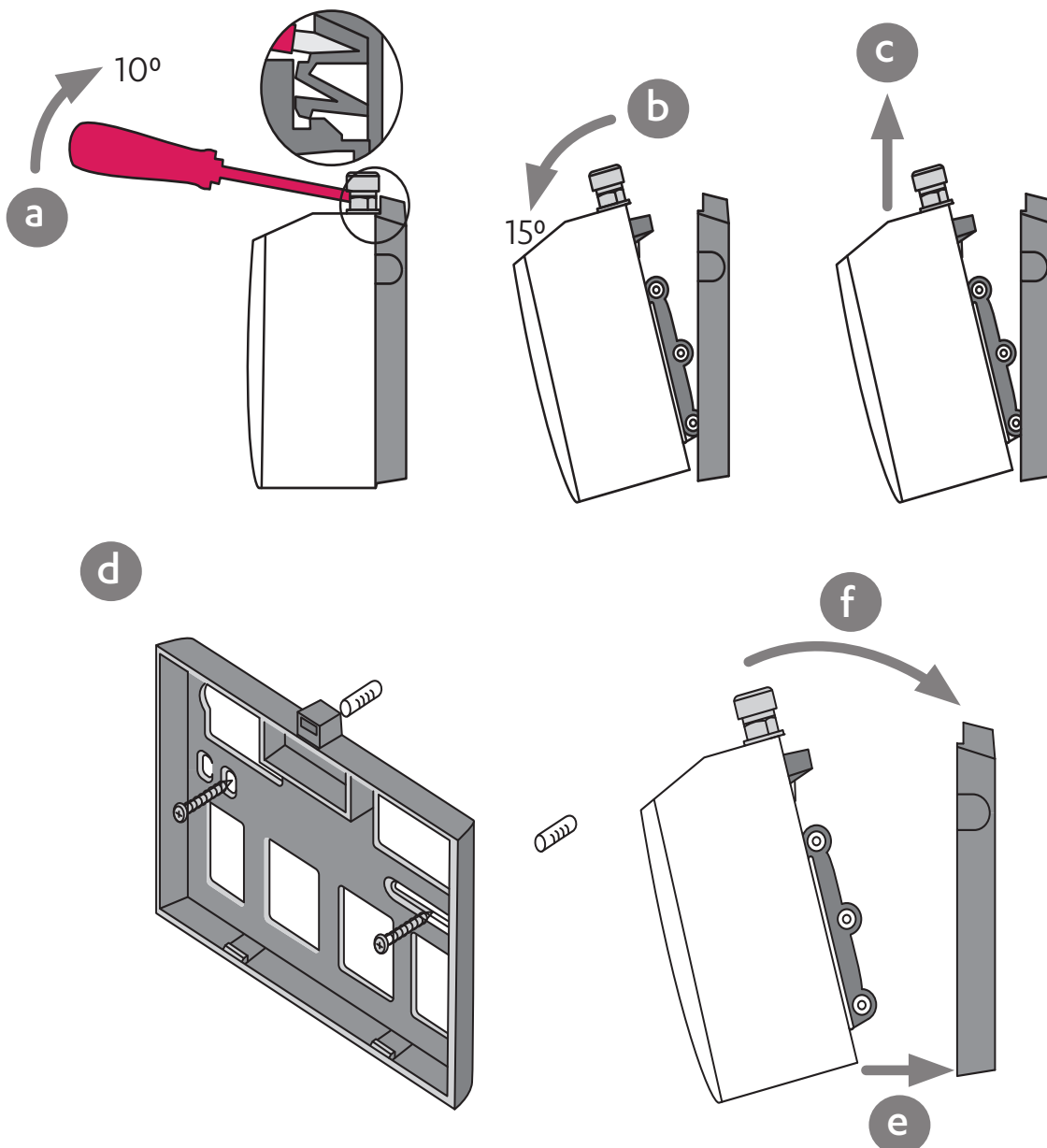

Note Take care not to break the clips when removing or installing the Booster.

SECTION 10: Connect the Booster

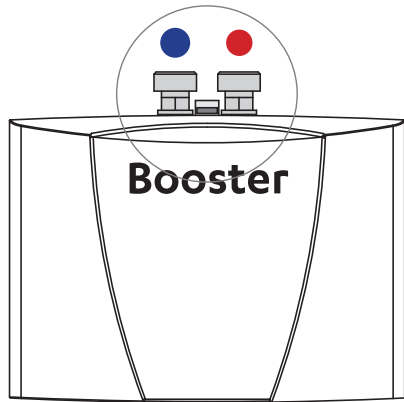

Do not connect to electrical power until commissioning.
Do not over tighten hose connections.
Braided hoses supplied cannot be lengthened.

Cold water into Booster,
connect to Command Centre
BYPASS OUT
see pages 19,20

Hot water out of Booster,
connect to Command Centre
BYPASS IN
see pages 19,20

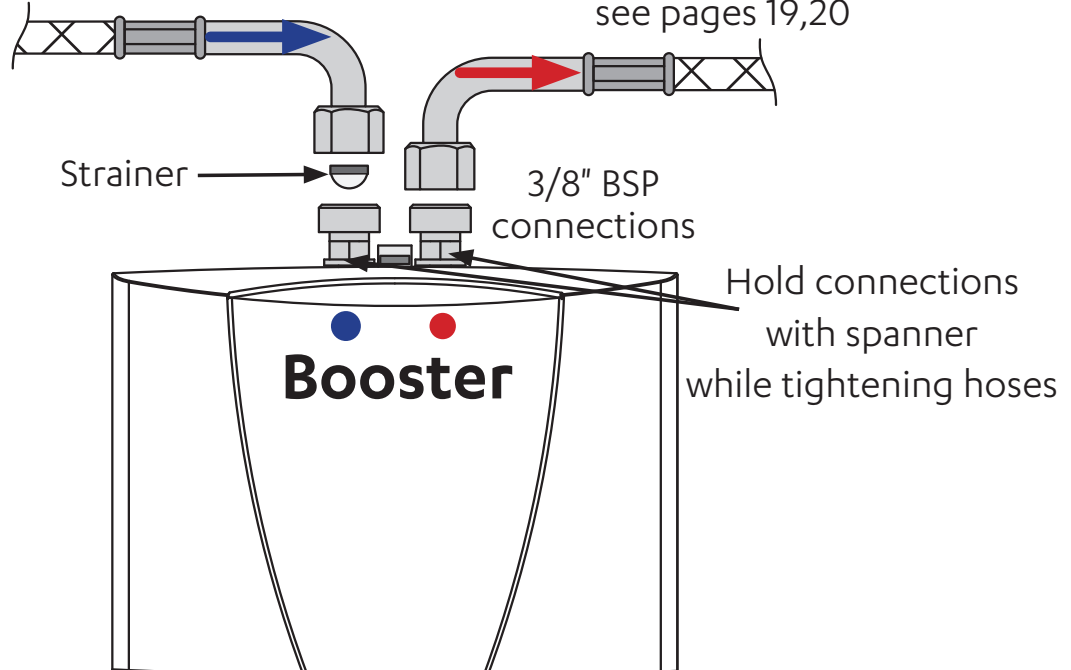

Generic installation instructions



For HydroTap, mixer tap and any optional accessories, use instructions supplied with individual kit components.

Mains power cable

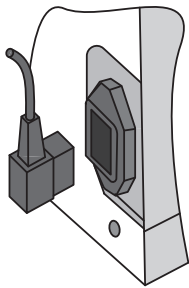

Do not connect to the mains socket until commissioning

USB

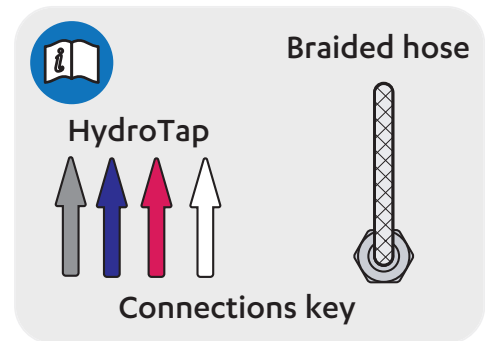
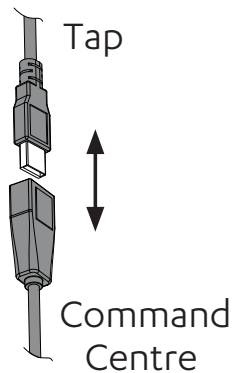

Installation diagrams are for illustrative purposes only.
Hoses are not shown to scale and cannot be lengthened.

Tips for hose connection

- Push the silicone hose over the connector for a minimum of 15mm.
- Ensure there is a constant fall from the tap down to the command centre.
- Hoses must be trimmed to avoid loops and kinks. Take care when positioning before cutting and make a clean cut straight across the hose, using a sharp blade.
- The hoses must not be under tension when installed.

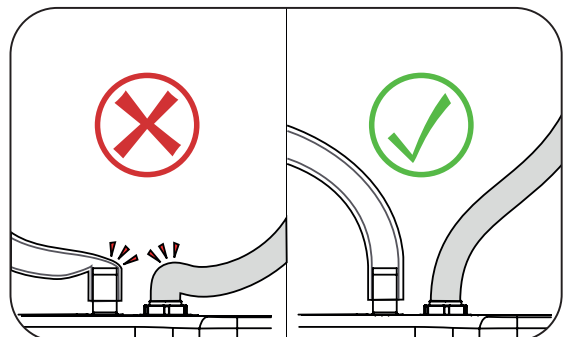
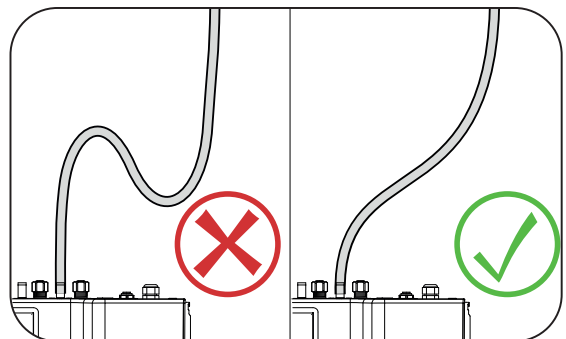

SECTION 11: Connect the Command Centre

BC40, BC60, BC100 models

Booster (selected models) and limescale filter (optional)

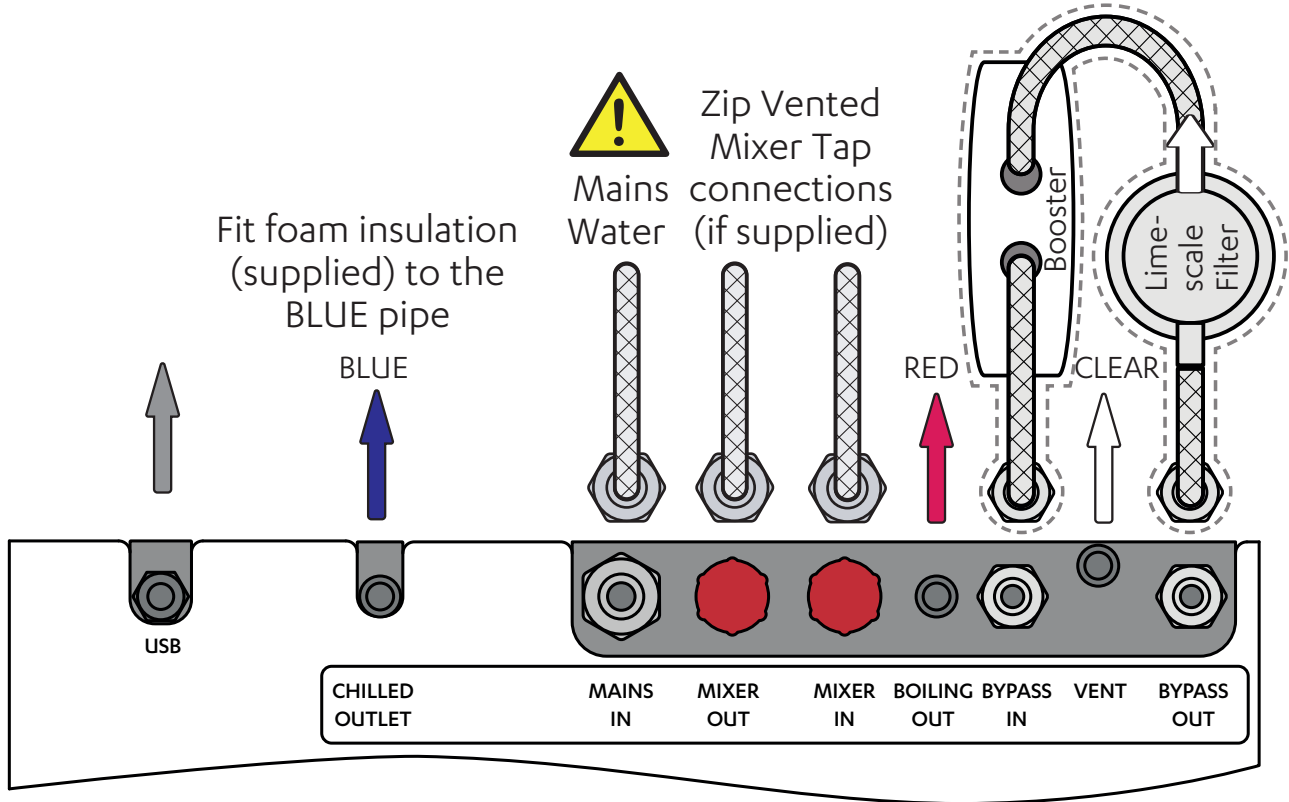

Example installation

Diagram for illustrative purposes only. Hoses are not shown to scale, as the booster hoses cannot be lengthened.

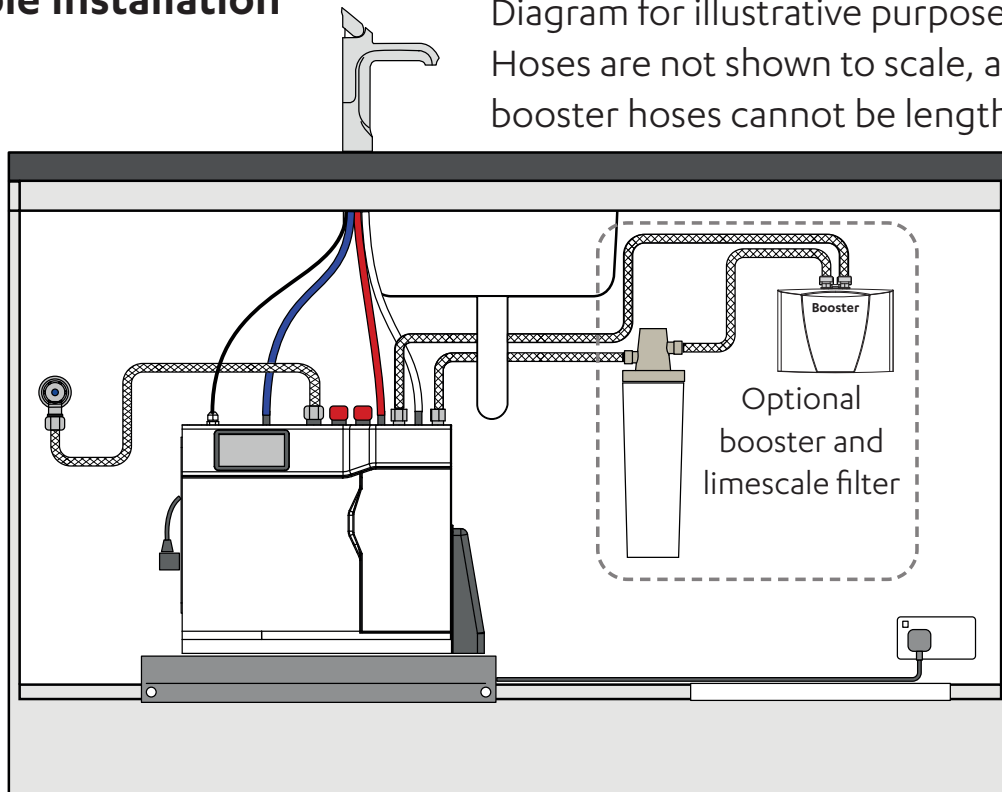

SECTION 11: Connect the Command Centre

BC20, BC30, BC Home models

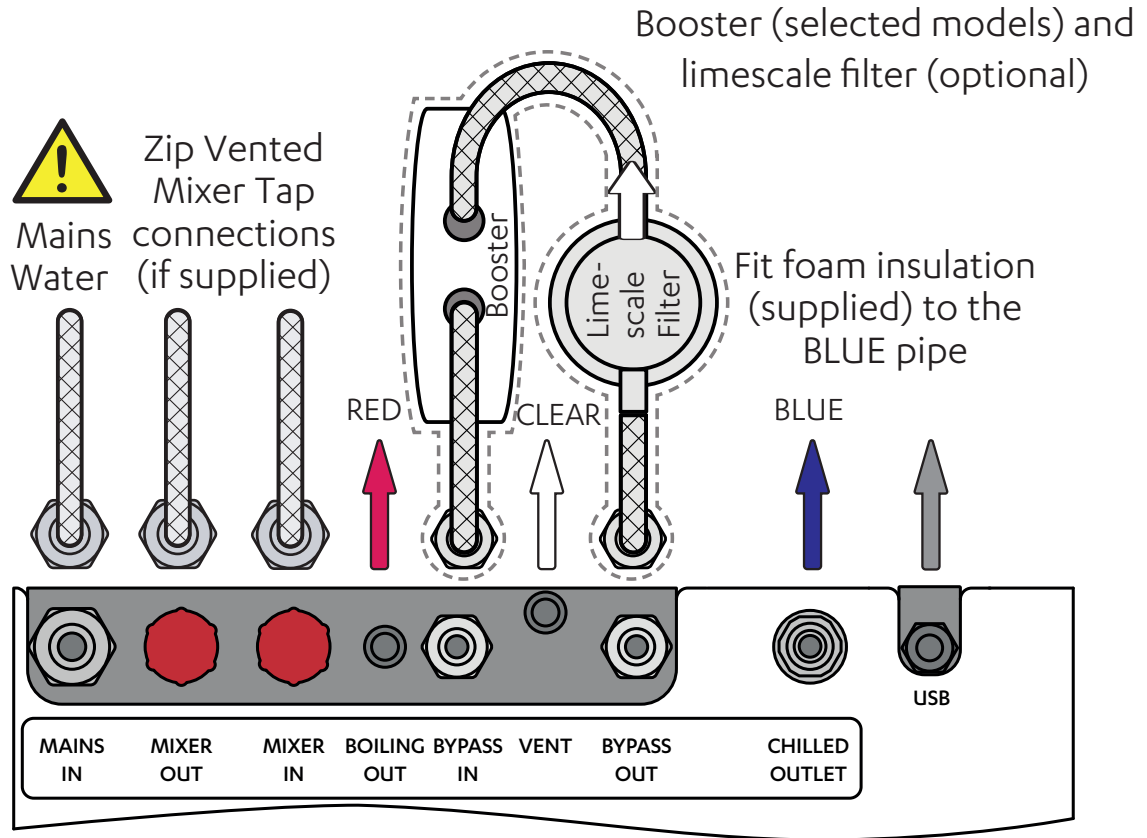

Example installation

Diagram for illustrative purposes only. Hoses are not shown to scale, as the Booster hoses cannot be lengthened.

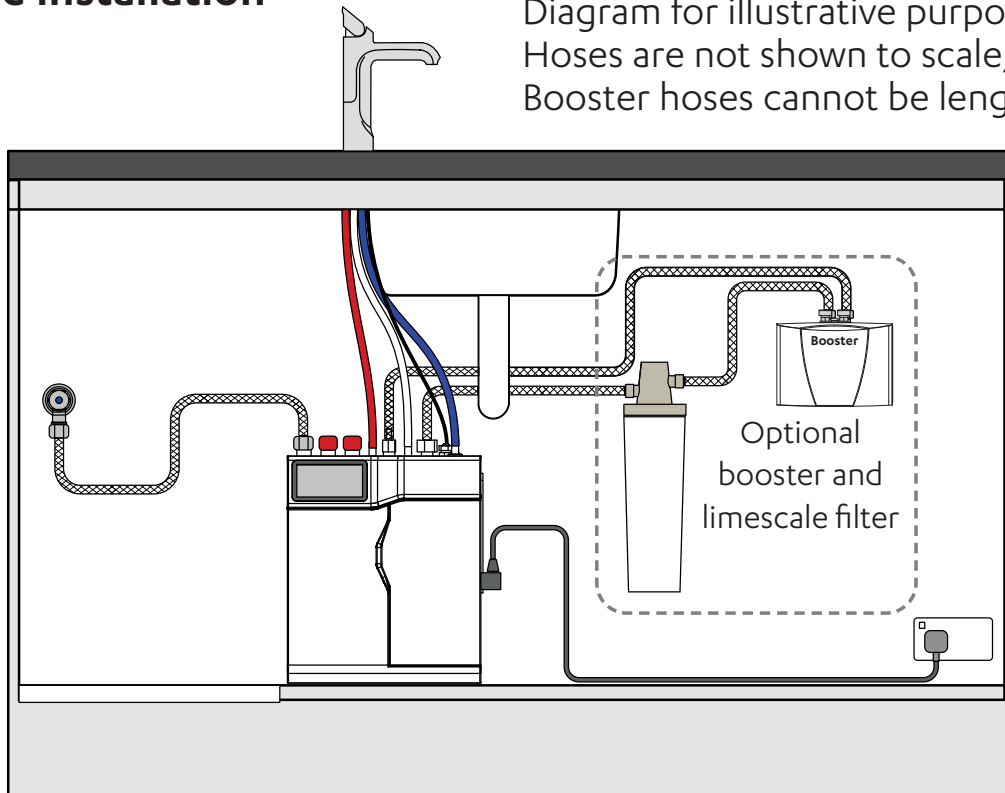

SECTION 12: Commissioning

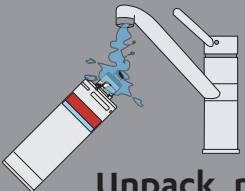

1  See User Guide

Unpack, moisten o-rings & fit filter

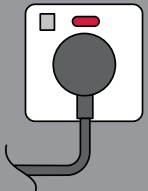
2 

Connect electricity

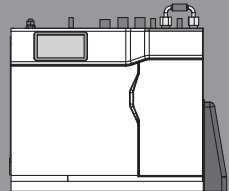
3 

Monitor display screen

4 

Set Language

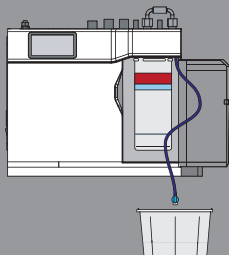
5 

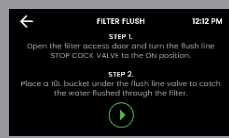
5 

Filter flush

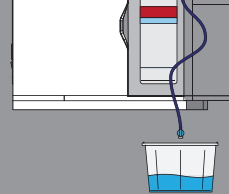
5 

Flush 10 Litres through

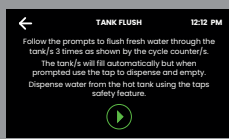
6 

Tank flush

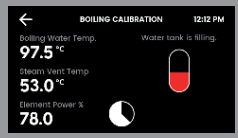

Dispense water as instructed

7 

Boiling calibration

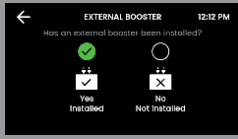
8 

Boost enable if Booster fitted

9 

Power off
Pull levers forward
Power on

Safety calibration (if required; Classic Tap only)

Notes

Notes

Refer to User Guide for operation and maintenance.



Zip Water (Australia) Pty Ltd

ABN 46 000 578 727

67 - 77 Allingham Street, Condell Park NSW 2200

Postal: Locked Bag 80, Bankstown 1885

Australia

Tel (+612) 9796 3100

Free call 1800 947 827 (1800 ZIP TAP)

www.zipwater.com



Zip Water UK

Trafalgar House, Rash's Green,

Dereham, Norfolk, NR19 1JG

0345 6 005 005

sales@zipindustries.co.uk

specify.zipwater.co.uk

